

# Montessori Matters



*Elementary students engage in large works! (left) The Square of the Decanomial; (middle) the Checkerboard for long multiplication (35,276 x 429); (right) a 3-dimensional puzzle of the globe.*

## In This Issue

Community 200 .....	1
Homework.....	3
The Globe .....	3

# Community 200

By Dr. Paul Epstein

## Enjoy Spring Break!



## On the Calendar

### March

29-31 School Closed—Spring Break

### April

1-2 School Closed—Spring Break

24 Springtime Revelry

The School is now growing in many exciting ways, and we summarize our growth with the phrase, “Community 200.” Community refers to all of us. The 200 refers to the number of children who will be enrolled in the School as we grow from our current size and offer the Montessori/International Baccalaureate Program through the eighth grade. We’re growing the school because we want to do more for each child; specifically, we will

- ✓ Build a 14,000 square foot addition to the existing building.
- ✓ Become a Spanish immersion school.
- ✓ Integrate the creative and performing arts more fully into our curriculum.
- ✓ Develop the entire outdoor campus with age-appropriate learning activities.
- ✓ Integrate a more robust use of technology for instruction in our elementary and middle school programs.
- ✓ Become an International Baccalaureate middle school program.

Please read further for more information about Community 200.



New construction of our school's addition begins in April. The new addition will provide new elementary classrooms, a much larger art and music room, a science lab, larger library/media center, and a meeting area. We will use some of our current space to expand the toddler program and create a "toddler suite" as well as develop a new computer lab.

*Our existing building.*

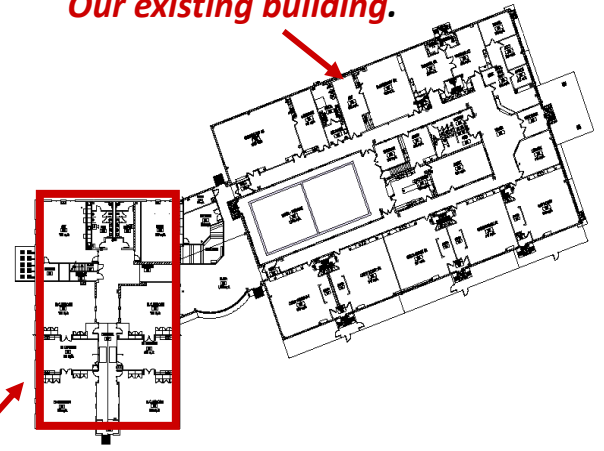

*The new addition.*

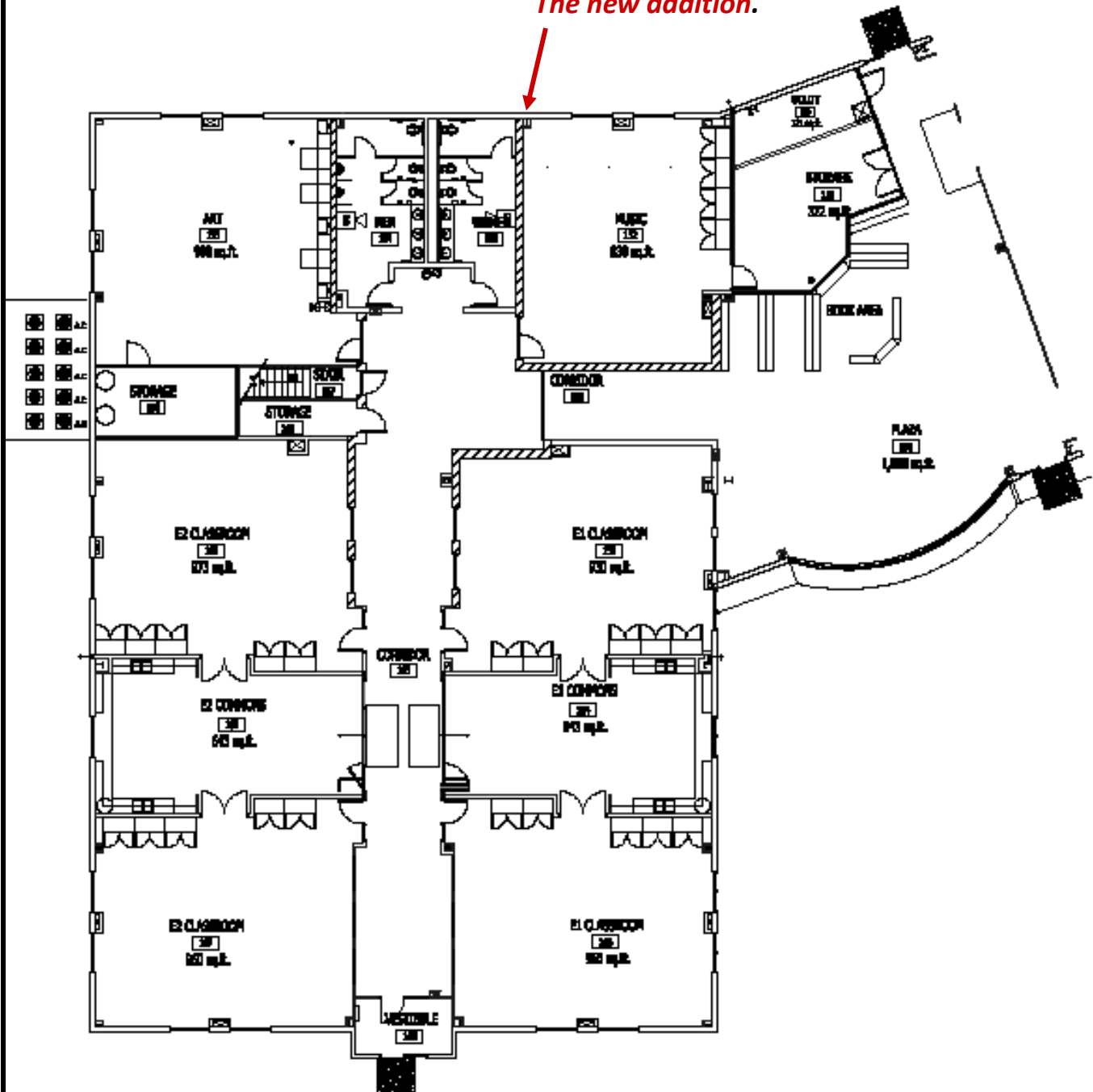

### ***Spanish Immersion***

As a Spanish immersion school, we will offer instruction four- or five-days a week to toddlers through the middle school. Children in the Children's House and Elementary programs will be able to use classroom materials printed in English and Spanish. Our goals include enabling fluency in speaking, reading, and writing.

### ***The Creative & Performing Arts***

We are planning to offer instrumental music instruction to children in the Children's House and Elementary Program. Later in April children and their parents will be able to attend an introductory evening and learn more about instruments and lessons.

### ***The Outdoor Campus***

Plans are now underway to increase how to use our outdoor campus. The ecology and environmental curriculum will focus on the concepts of energy flow, interrelationships, cycles, and change. A new afterschool studio is now available for children in Children's House, and gardening will begin shortly.

### ***Technology in Instruction***

The new addition frees up classroom space to develop a computer lab for elementary and middle school students in which they can further develop their keyboarding skills and learn to use a variety of productivity tools as well as various tools for digital recording, editing, and presentations.

### ***The International***

#### ***Baccalaureate Program (I.B.)***

The I.B. program is a natural fit for our future middle school students. They will be ready for a rigorous and challenging academic program that will more than ready them for high school. We plan to initiate the accreditation process with the I.B. organization this spring.

#### ***Community 200***

We invite and welcome your support of the Community 200 initiative. Please talk with me if you would like additional information and details.

---

## ***Homework!***

By Isabell Dyrbye Wright

Homework has now started in E2. Each student chooses what they want to take home. Most kids take home work that they have due later in the week. E1 has been doing this also. They have lessons, and then they have follow-up for homework. RMS now has homework, and this helps us practice time management skills. Homework also prepares us for middle school and high school because in high school loads of homework will come. Now E2 and E1 has to prepare to move on.

---

## ***The Globe***

By Isabell and Celeste Dyrbye-Wright and Eva Aphonse

Three E2 students, Eva, Isabell, and Celeste, have worked on a 3-D globe with 540 puzzle pieces. (Please see our picture on page 1.) We worked on it for

about 2 weeks and 2 days. We finished it on March 23, 2010.

The globe is about 9 ½ inches tall and wide. The globe is like the modern day globe children use in their classrooms. The globe has labeled capitals and bodies of water. The E2 students took different jobs like sorting out puzzle pieces and putting them together. The students did this for choice work, and together we made this globe.

